

SECTION A-A

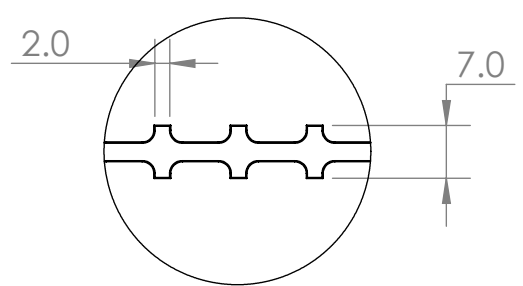

DETAIL B  
SCALE 1 : 1

- Note:**
- 1) Material to be 64g/l density(4.0 lb/ft3)  
Static Dissipative EPS
  - 2) 1 Degree Draft TYP.
  - 3) Dimensions shown are in millimeters

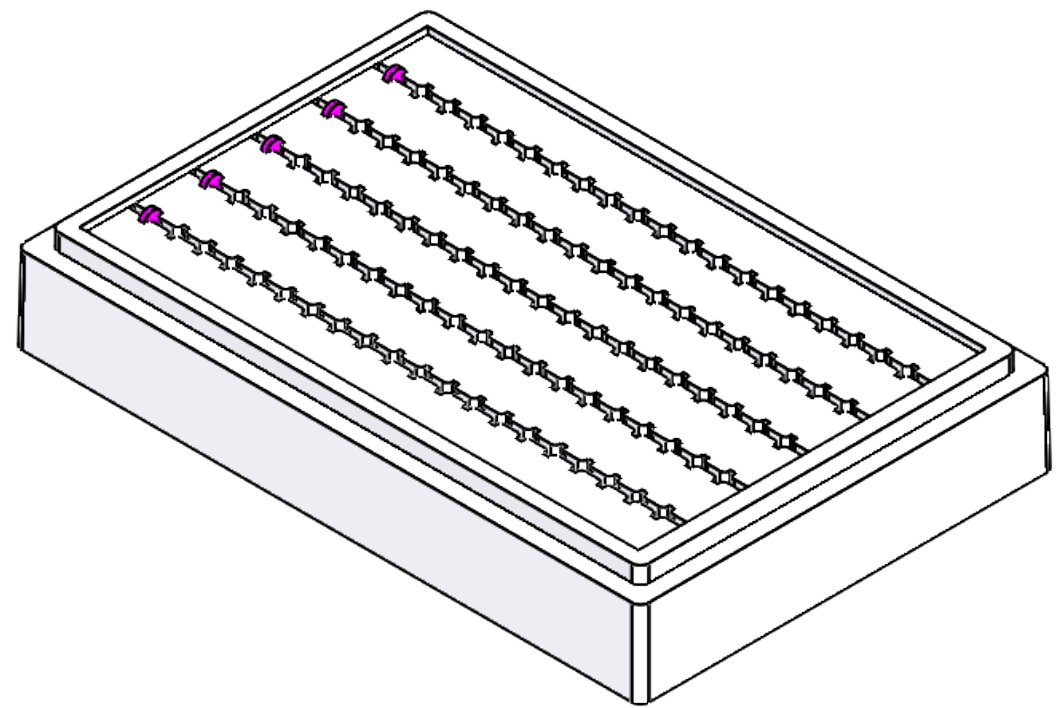
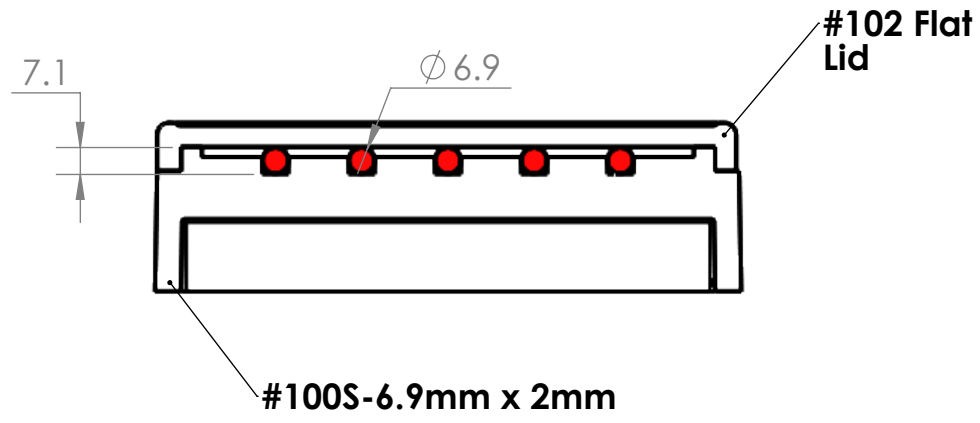

**PROPRIETARY AND CONFIDENTIAL**  
THE INFORMATION CONTAINED IN THIS DRAWING IS THE SOLE PROPERTY OF <INSERT COMPANY NAME HERE>. ANY REPRODUCTION IN PART OR AS A WHOLE WITHOUT THE WRITTEN PERMISSION OF <INSERT COMPANY NAME HERE> IS PROHIBITED.

		UNLESS OTHERWISE SPECIFIED:	NAME	DATE	Tempo Plastic Co.			
		DIMENSIONS ARE IN MM	DRAWN	Junior	1/4/2023	TITLE:  100S-6.9mm x 2mm		
		TOLERANCES:	CHECKED					
		FRACTIONAL ±	ENG APPR.					
		ANGULAR: MACH ±    BEND ±	MFG APPR.					
		TWO PLACE DECIMAL    ±	Q.A.					
		THREE PLACE DECIMAL    ±	COMMENTS:			SIZE    DWG. NO.    REV <b>B</b> <b>A</b>		
		INTERPRET GEOMETRIC TOLERANCING PER:						
		MATERIAL						
		FINISH						
NEXT ASSY	USED ON							
APPLICATION		DO NOT SCALE DRAWING				SCALE: 1:2	WEIGHT:	SHEET 1 OF 1