

Using #102 Flat lid you can put upto 63.5 x 63.5 x 13.46mm

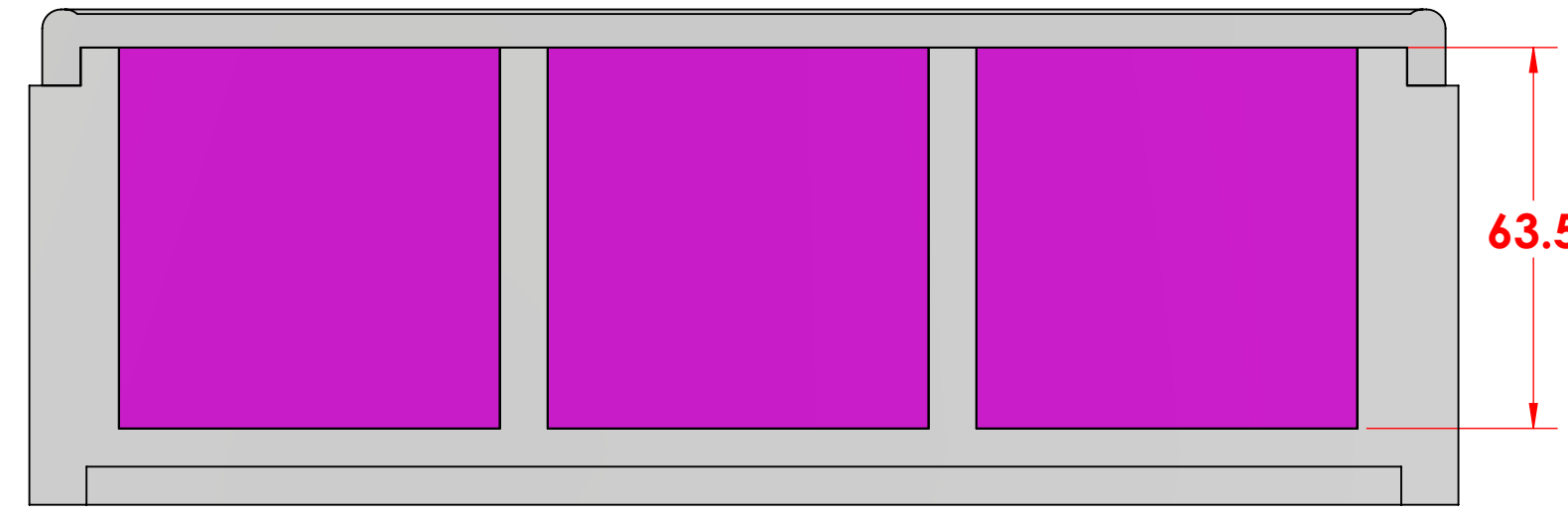

Using # 201-01 Lid you can put upto 90.17 x 63.5 x 13.46mm

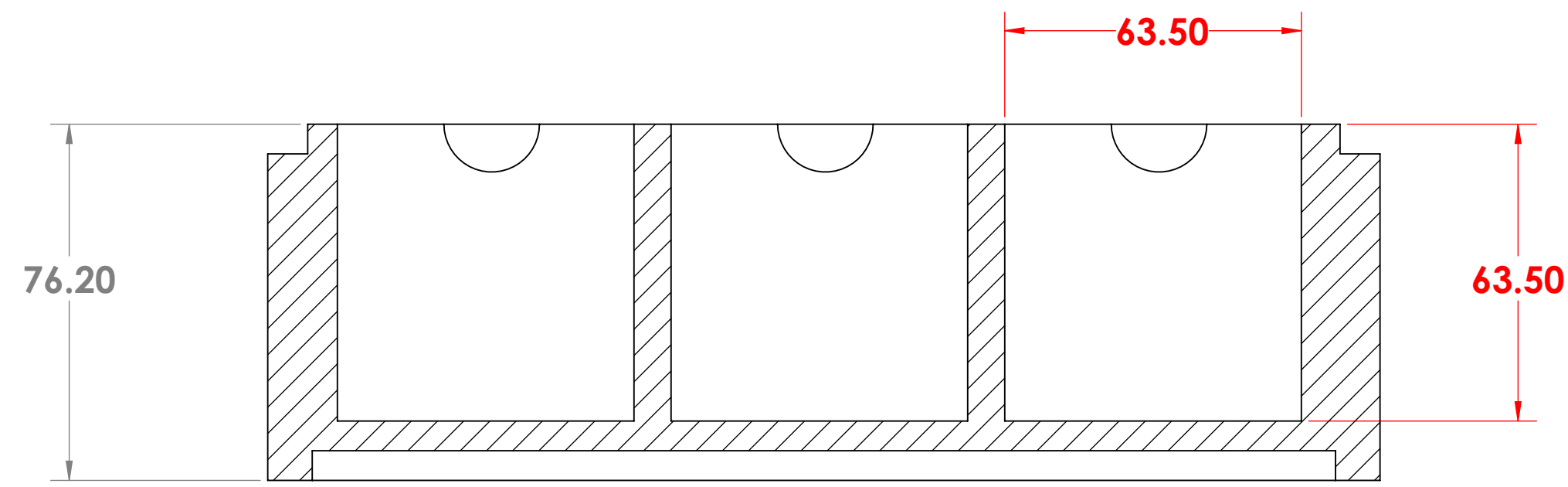
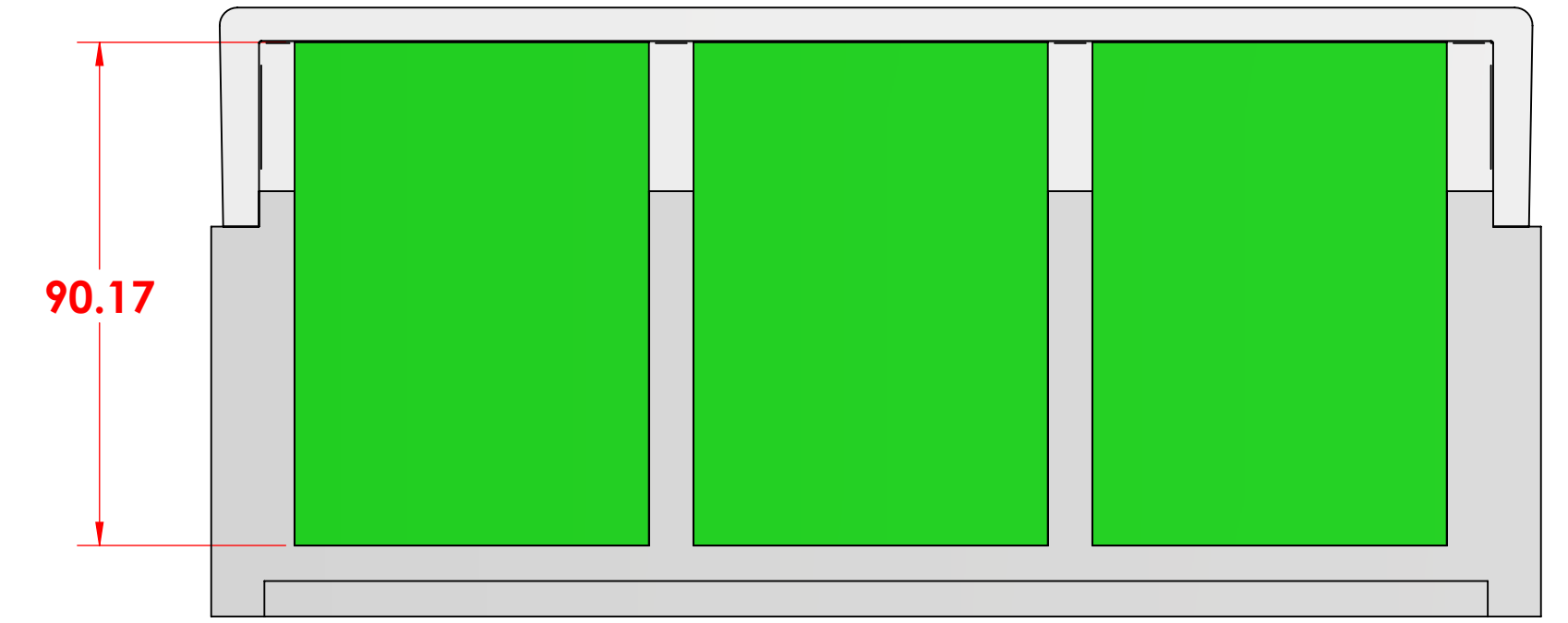

SECTION A-A
SCALE 1 : 1.25

Using #102 D lid you can put upto 79.37 x 63.5 x 13.46mm

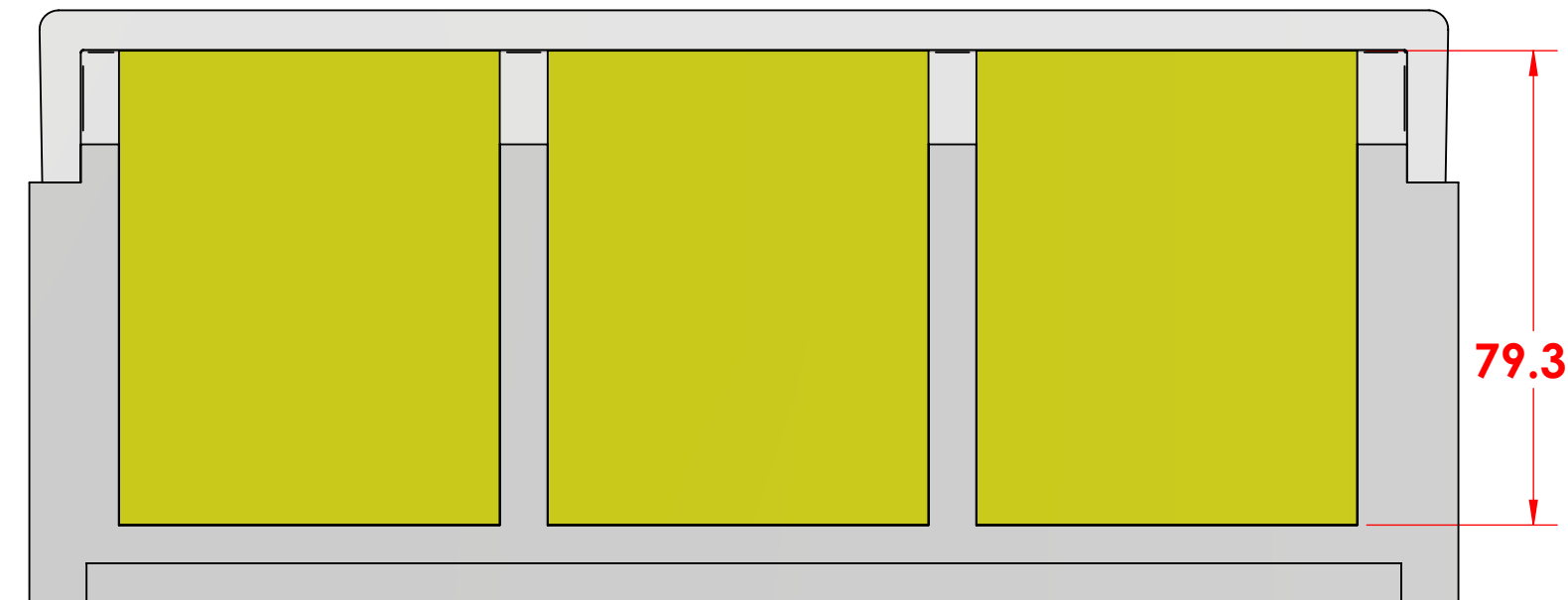

Using #102 DD lid you can put upto 104.77 x 63.5 x 13.46mm

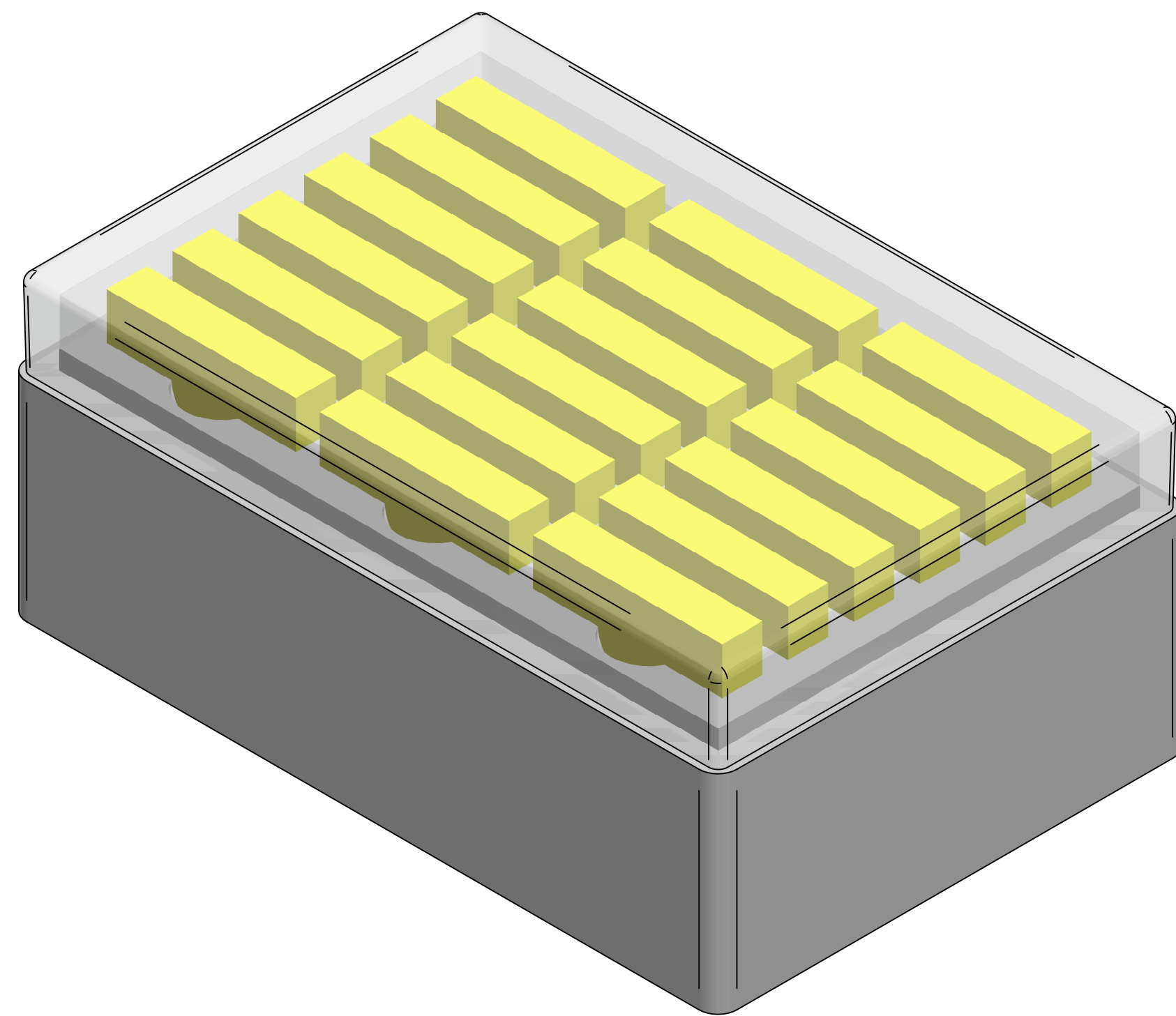
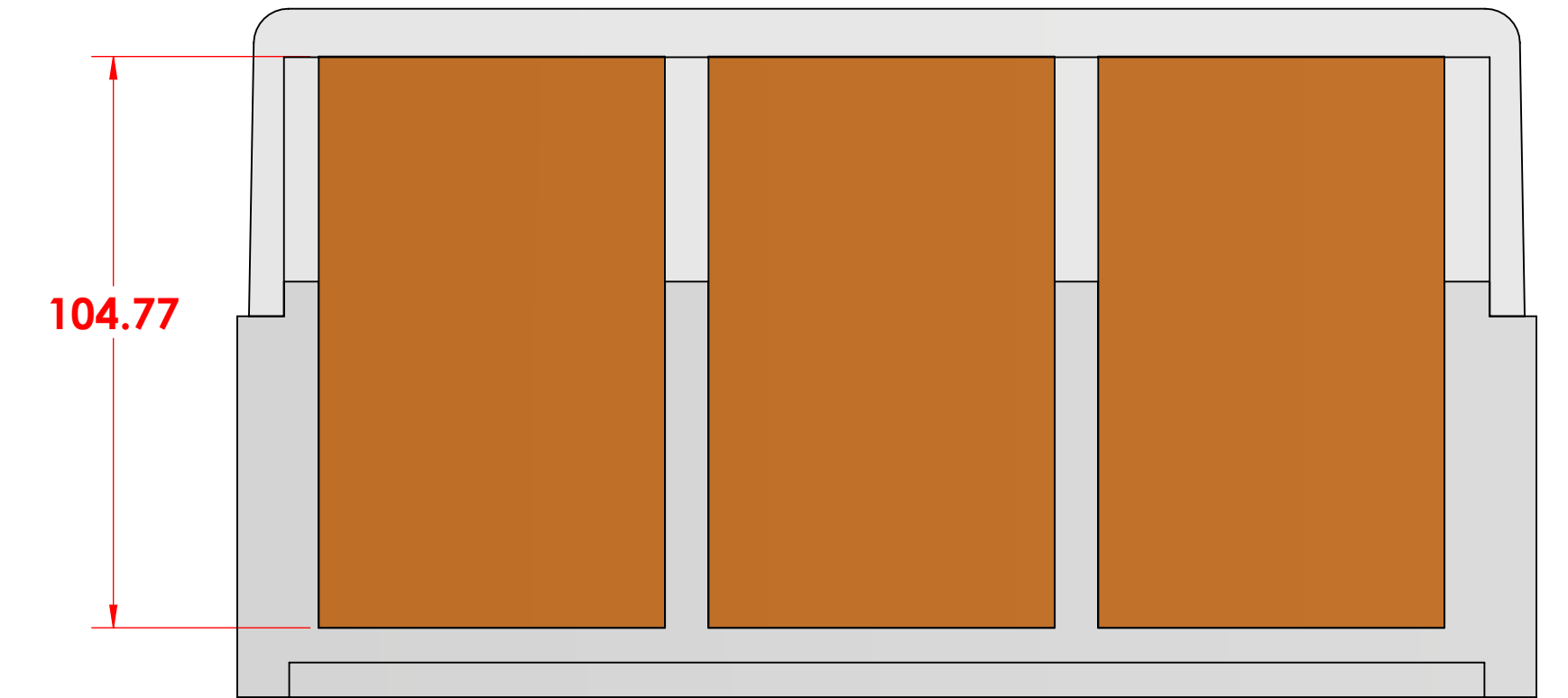

Note:

- 1) Deeper Lids available on request
- 2) Material To be 64g/l density (4.0 lb/ft3) EPS, Static Dissipative
- 3) Dimensions shown are in millimeters

PROPRIETARY AND CONFIDENTIAL
THE INFORMATION CONTAINED IN THIS
DRAWING IS THE SOLE PROPERTY OF
TEMPO PLASTIC CO., INC. ANY
REPRODUCTION IN PART OR AS A WHOLE
WITHOUT THE WRITTEN PERMISSION OF
TEMPO PLASTIC CO., INC IS
PROHIBITED.

UNLESS OTHERWISE SPECIFIED:		NAME	DATE	TEMPO PLASTIC CO., INC.
DIMENSIONS ARE IN MM		JR	1/9/2018	
TOLERANCES:				TITLE:
FRACTIONAL	±			#120
ANGULAR	±			SIZE DWG. NO.
TWO PLACE DECIMAL	±			D
THREE PLACE DECIMAL	±			REV
INTERPRET GEOMETRIC TOLERANCING PER:				A
MATERIAL				SCALE: 1:1.25 WEIGHT:
FINISH				SHEET 1 OF 1
NEXT ASSY	USED ON			
APPLICATION	DO NOT SCALE DRAWING			