

- Note:
- 1) Material To be 23g/l density (7.0 lb/ft<sup>3</sup>) EPS W/Anti-Stat parts to weigh 20g minimum
  - 2) 1 Degree Draft TYP
  - 3) Volume = 13.3 cubic inches
  - 4) Check flatness on layout table

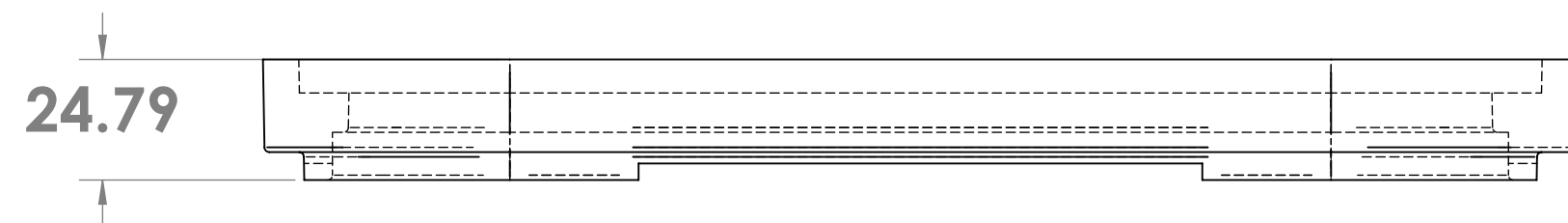

254mm Dia.  
Wafer

Section view

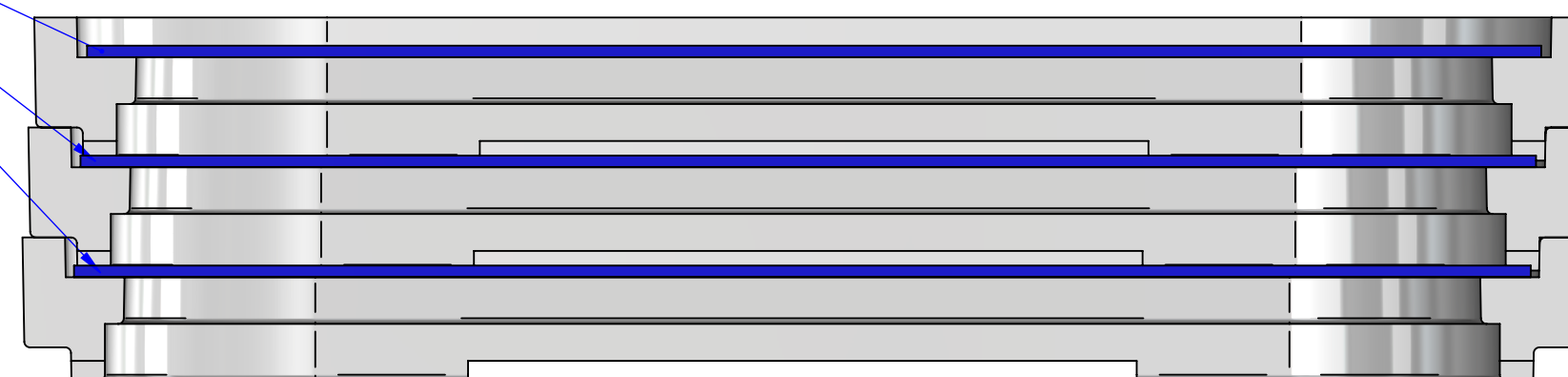

PROPRIETARY AND CONFIDENTIAL  
THE INFORMATION CONTAINED IN THIS  
DRAWING IS THE SOLE PROPERTY OF  
TEMPO PLASTIC CO., INC. ANY  
REPRODUCTION IN PART OR AS A WHOLE  
WITHOUT THE WRITTEN PERMISSION OF  
TEMPO PLASTIC CO., INC IS  
PROHIBITED.

UNLESS OTHERWISE SPECIFIED:		NAME	DATE	TEMPO PLASTIC CO., INC.
DIMENSIONS ARE IN MM		JR	1/18/2018	
TOLERANCES:		DRAWN		TITLE:
FRACTIONAL ±		CHECKED		#1R-10000
ANGULAR: MAACH ± BEND ±		ENG APPR.		SIZE DWG. NO. REV
TWO PLACE DECIMAL ±		MFG APPR.		D A
THREE PLACE DECIMAL ±		Q.A.		SCALE: 1:2 WEIGHT: SHEET 1 OF 1
INTERPRET GEOMETRIC TOLERANCING PER:		COMMENTS:		
MATERIAL				
FINISH				
NEXT ASSY	USED ON			
APPLICATION		DO NOT SCALE DRAWING		