

SECTION A-A
SCALE 1 : 1

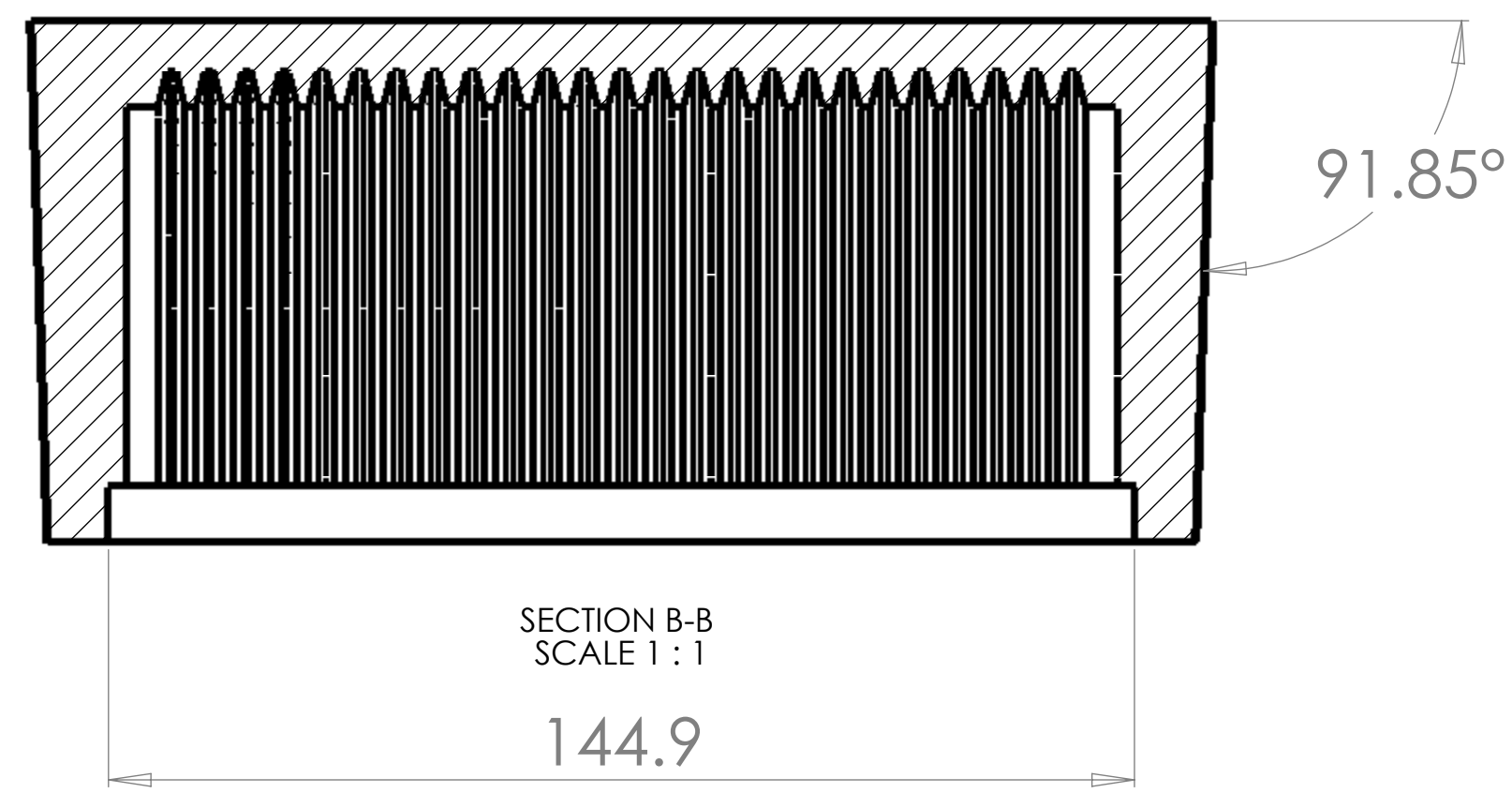

SECTION B-B
SCALE 1 : 1

Note:

- 1) Material To be 64g/l density (4.0 lb/ft³) EPS
- 2) 1 Degree Draft TYP
- 3) Volume = 100.6 cubic inches

PROPRIETARY AND CONFIDENTIAL

THE INFORMATION CONTAINED IN THIS DRAWING IS THE SOLE PROPERTY OF Tempo Plastic Co. Inc. ANY REPRODUCTION IN PART OR AS A WHOLE WITHOUT THE WRITTEN PERMISSION OF Tempo Plastic Co. Inc IS PROHIBITED.

| | | | |
|--------------------------------------|---------|-------------------------|--------|
| UNLESS OTHERWISE SPECIFIED: | | NAME | DATE |
| DIMENSIONS ARE IN Millimeters | | Junior | 8/2/07 |
| TOLERANCES: | | CHECKED | |
| FRACTIONAL ± | | ENG APPR: | |
| ANGULAR MATCH ± | BEND ± | MFG APPR: | |
| TWO PLACE DECIMAL ± | | G.A. | |
| THREE PLACE DECIMAL ± | | | |
| INTERPRET GEOMETRIC TOLERANCING PER: | | 1227 N. Miller Park Ct. | |
| MATERIAL | | Visalia, CA 93291 | |
| NEXT ASSY | USED ON | FINISH | |
| APPLICATION | | | |

Tempo Plastic Co, Inc.

TITLE:
100R-2562

SIZE DWG. NO. REV
D **A**
SCALE: 1:1 SHEET 1 OF 1